

## 5 Video Camera/Games Console to TV

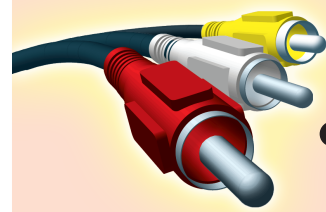

### Composite Audio/Video

- A** Connect the video cable (yellow) from the video output on camera (or other device) to the video input (yellow) located on the side of TV.
- B** Connect audio cables (red/white) from audio outputs on device to audio inputs (red/white) on the side of TV.  
Note: for mono devices, connect only white audio cable from device's audio output to white audio input on the side of TV.
- C** Turn on TV and the device. Press the AV button on the remote control until FRONT/SIDE appears on TV screen.
- D** Press PLAY on the device to verify connection.

### Other Possible Connections



**S-Video**  
Refer to panel 4.

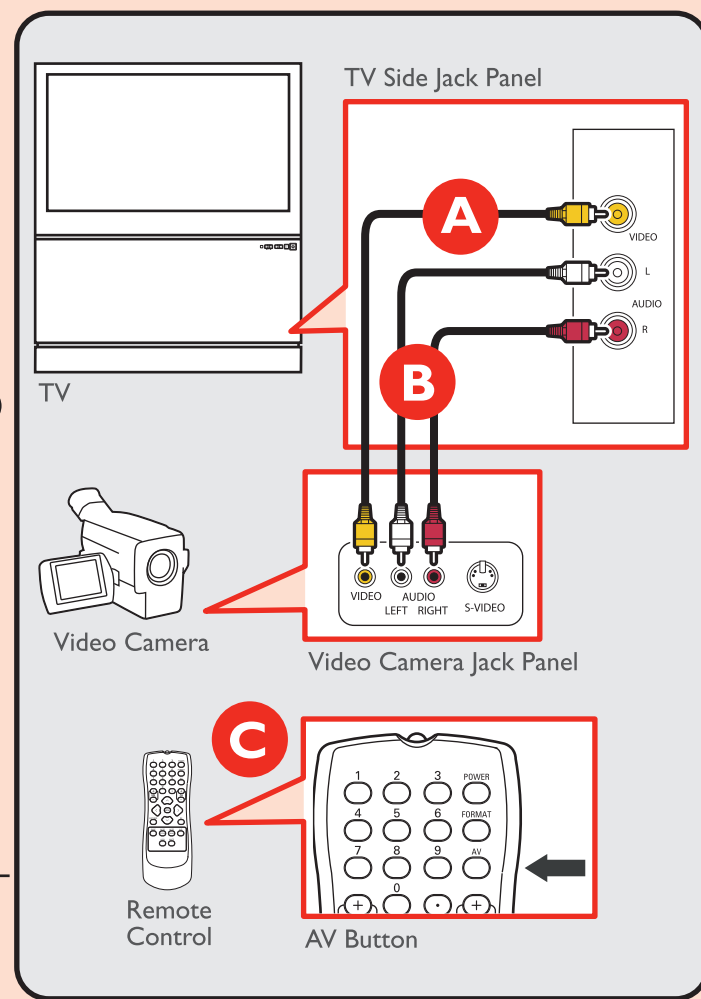

**MAGNAVOX**  
SMART. VERY SMART.

## How to make the best connection

Use this guide to achieve the optimal connection for each of your components. Alternative connections are also provided.

### Connection Basics



**Better**



**Good**



**Basic**



**Basic**

#### Component Video Input

Provides superior picture quality by separating the green, blue and red luminance signals. Typically used with red/white audio cables.

#### S-Video

Supplies a better picture than RF and Composite connections. Used with red/white audio cables.

#### Composite Audio/Video

Separate video (yellow) and audio (red/white) cables that provide a basic connection from the cable box and other devices. Note: The color of audio inputs may differ, e.g. red/white or red/black.

#### RF

Provides a basic connection for antenna or cable. Provides both audio and video.

## 1 Set-Top Box to TV

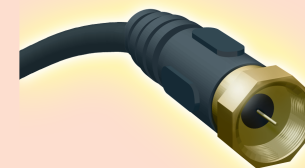

### RF Cable

- A** Connect RF cable from wall to input at the back of the cable box.
- B** Use second RF cable to connect the cable box to the TV input (75  $\Omega$ ).  
Note: This connection gives mono sound. For stereo sound use also composite audio/video connection (Refer to panel 3).
- C** Set output switch on set-top box to CH 3 or 4 and tune TV to same channel.

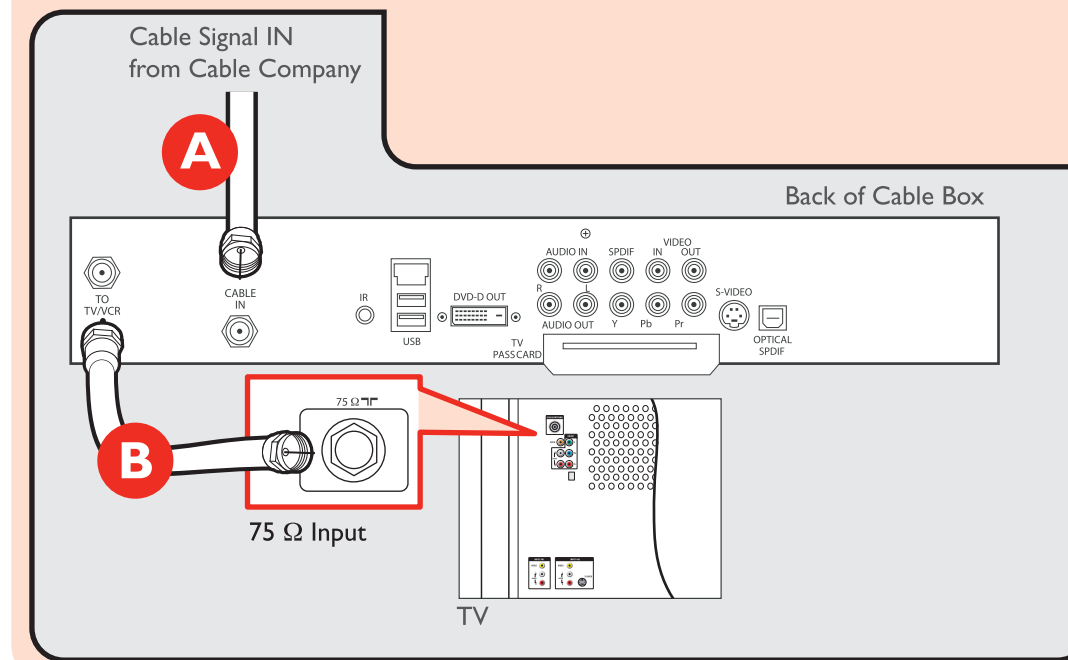

### Other Possible Connections



**Component Video**  
Refer to panel 2.

## Need more help?

### User manual:

Check the user manual that came with your TV.

Online help: [www.usasupport.magnavox.com](http://www.usasupport.magnavox.com)

## 2 DVD Player or DVD Recorder to TV

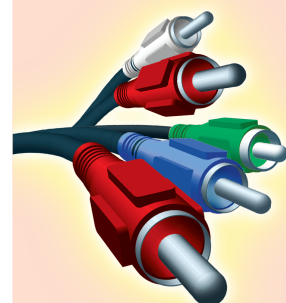

**HD CVI (Component Video Input)**  
(only for HD devices)

**A** Insert Component Video connectors into their corresponding jacks on both HD DVD player/HD DVD recorder and TV (HD CVI-Y, Pb and Pr).

**B** Connect red/white audio cables into the audio output jacks on DVD player/DVD recorder and audio AV inputs on TV.

**C** Turn on TV and DVD player/DVD recorder. Press AV on remote control until HD CVI appears on TV screen.

**D** Insert a pre-recorded DVD into DVD player/DVD recorder and press PLAY to verify correct connection.

Note: HD CVI gives the best high definition picture. When using HD CVI, it is best not to connect a video signal to the AV input on the TV.

### Other Possible Connections



**S-Video**  
Refer to panel 4.



**Composite Audio/Video**  
Refer to panel 5.

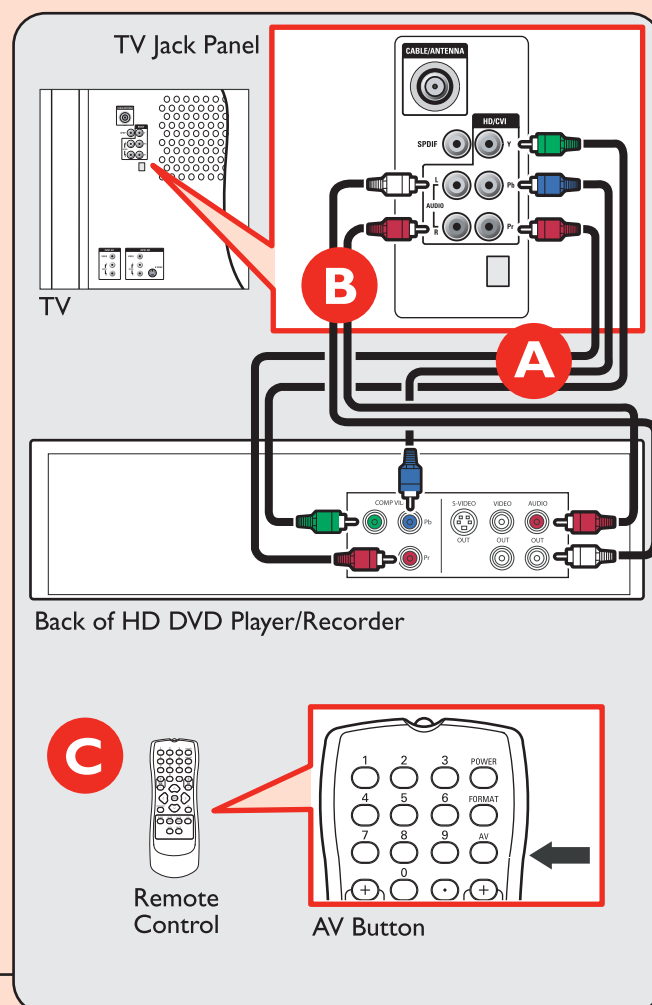

## 4 VCR to TV

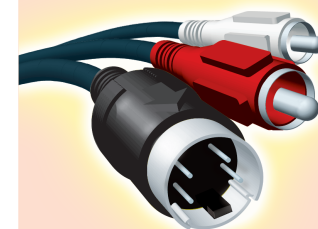

**S-Video**

**A** Connect S-Video cable to S-Video input on back of TV and S-Video output on back of VCR.

**B** Connect audio cables (red/white) to audio AV inputs on back of TV and Audio outputs on back of VCR.

**C** Turn on TV and VCR. Press AV button on the remote control until AV1 or AV2 appears on TV screen.

**D** Insert pre-recorded videotape into VCR and press PLAY to verify correct connection.

Note: When you connect S-Video and AV2 at the same time, you can only hear sound coming from S-Video.

OR

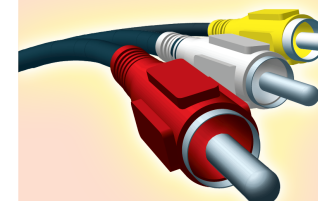

**Composite Audio/Video**

**A** Connect the video cable (yellow) to the VIDEO AV input on back of TV and the corresponding video output on back.

**B** Connect audio cables (red/white) to audio AV inputs on back of TV and the corresponding audio outputs (L & R) on back of VCR.

**C** Turn on the TV and VCR. Press AV button on the remote control until AV1 or AV2 appears on TV screen.

**D** Insert pre-recorded videotape into VCR and press PLAY to verify correct connection.

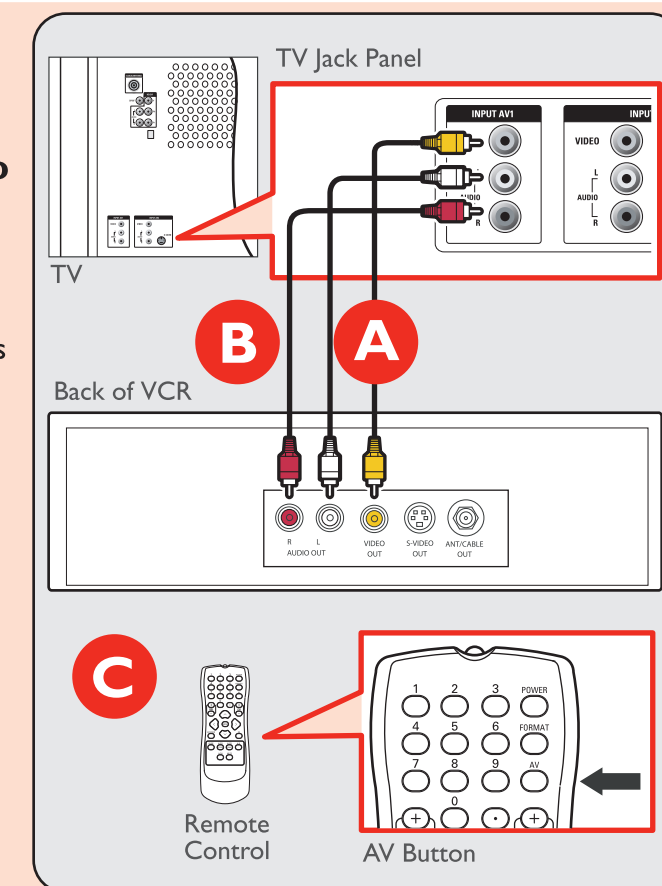
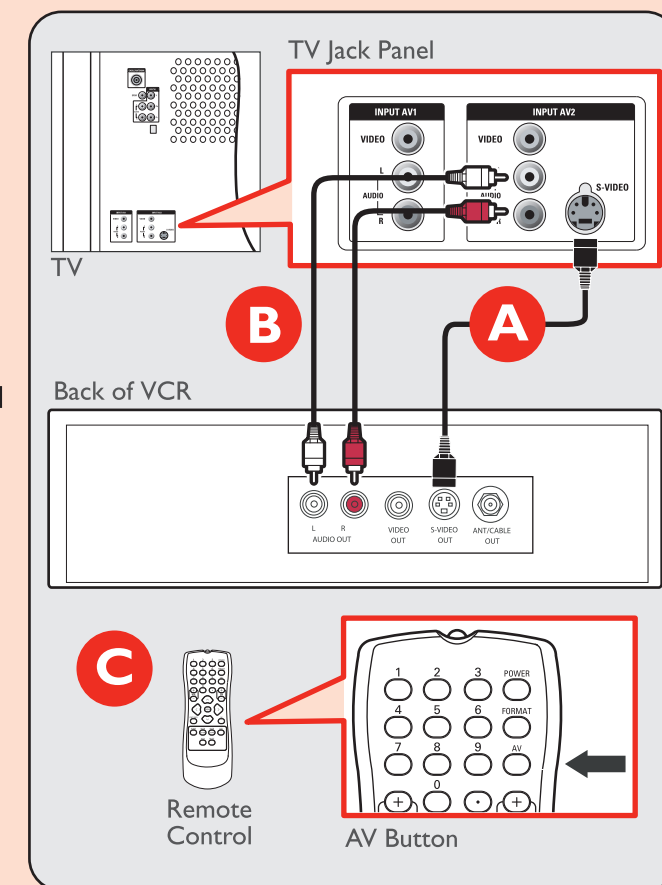

## 3 Audio to Hi-fi System

**A** Connect audio cable from the SPDIF jack on the rear of the TV to the DIGITAL IN jack on the rear of the hi-fi system.

Note: SPDIF (Sony and Philips Digital Interconnect Format) is highly recommended for high quality digital sound output.

